



FLORIDA DEPARTMENT OF HEALTH – BREVARD COUNTY
 Environmental Health Services
 2725 Judge Fran Jamieson Way, Suite A116
 Viera, Florida 32940-6605
 PHONE: 321/633-2100 FAX: 321/633-2151
 www.BrevardEH.com

Collecting a Bacteriological Water Sample for Analysis

It is recommended your potable well is tested for bacteria. You should submit a distribution sample (i.e. from the kitchen sink). If you have a disinfection system (i.e. Chlorinator), it is recommended to submit a raw sample (prior to treatment, a hose spigot closest to the pump) along with a distribution sample (after treatment). If taking a raw and a distribution sample, label each bag with the source (well or kitchen) that the sample came from.

IF THIS IS FOR A WATER LINE BREAK OR BOIL WATER NOTICE - NOTIFY DEPARTMENT FOR PROPER PROTOCOL FOR LOCATION AND NUMBER OF SAMPLES TO BE TAKEN.

Water sampling must be collected carefully to prevent contamination. The collector should follow these steps for accurate results. If you have any questions, please call (321) 633-2100 ext 9392.

Protocol:

- All samples must be delivered to Environmental Health Services (EHS) **within two (2) hours of collection.** (address listed below)
- All samples must be stored in a cold and clean refrigerator or cooler.
- All samples must be transported to EPHS **on ice** inside a cooler.
- You may only use an approved sample container provided by the department. EPHS can provide this (THIO-BAG) to you.
- Never touch or allow open bag to touch any surface. Do not remove the white tablet.

SAMPLE SUBMITTAL DAYS AND TIMES
Monday - Wednesday: 8:00 am to 4:30 pm
Thursday: 8:00 am to 10:00am
*****NO SAMPLES ARE ACCEPTED ON FRIDAY*****

Collection Directions:

1. Prior to filling the sample bag with water, write the owner's name, address of the sample site, sample location (i.e. well, kitchen sink, hose bib, etc), and date & time of collection, in permanent ink (sharpie) on the sample bag.
2. Remove screen from spigot or fixture.
3. Disinfect the faucet or tap at opening with liquid bleach. Try to spray bleach up into the mouth of the tap or faucet. Wait 60 seconds.
4. Flush line by running water for at least five minutes, or until service line is clear. It is important to flush the line of any bacterial growth since the water was last used.
5. Adjust flow through tap to the diameter of a pencil.

Fill sample bag slightly ABOVE the 4 oz fill line. Seal the bag by carefully by whirling bag in the direction away from you, then bend each side of wire tab in the direction away from you as well and twist together. Close tightly to avoid leakage. Bag must be full past the 100 ml line when tightly closed. Samples with less than 100ml will be rejected - lab needs sufficient volume.

6. Place sample **on ice** in a clean cooler & transport to the EPHS office.

COMPLETE THE ENCLOSED SAMPLE COLLECTION FORM AND SUBMIT WITH YOUR SAMPLE(S).

Directions on how to complete the form are located on the back of the sample form.

If applicable, for PWS I.D. enter your DEP facility ID, Limited Use Permit, or Well Construction Permit number.

PLEASE TURN PAGE OVER FOR DIRECTIONS ON HOW TO USE THE THIO-BAG

THIO-BAG®

Instructions for Whirl-Pak® THIO-BAGS®

Caution: Do not allow the thio tablet to fall out of the bag.

OPENING

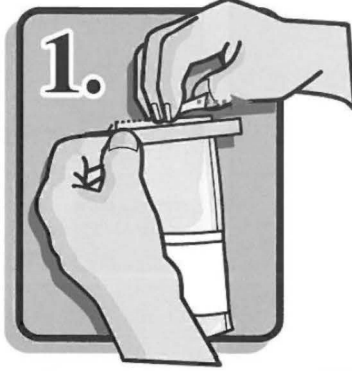

Tear off top along perforation.

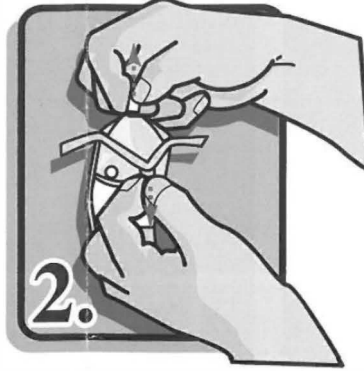

Pull tabs outward to open bag. Sometimes a pull on the bottom is also helpful.



Fill bag to required fill line. The 4 oz. fill line will ensure that 100 mls are collected.

CLOSING

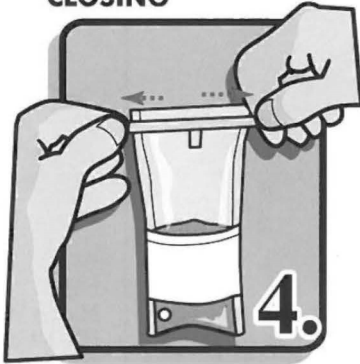

Pull wire ends to close bag.



Whirl bag three complete revolutions. (Do not roll tapes down.) Leave airspace for mixing in lab.



Turn tape inward on opposite face of fold.

NASCO • FORT ATKINSON, WISCONSIN • MODESTO, CALIFORNIA SPECTRUM/NASCO • NEWMARKET, ONTARIO, CANADA
 PRINTED IN U.S.A. U05352 /RV 9-09

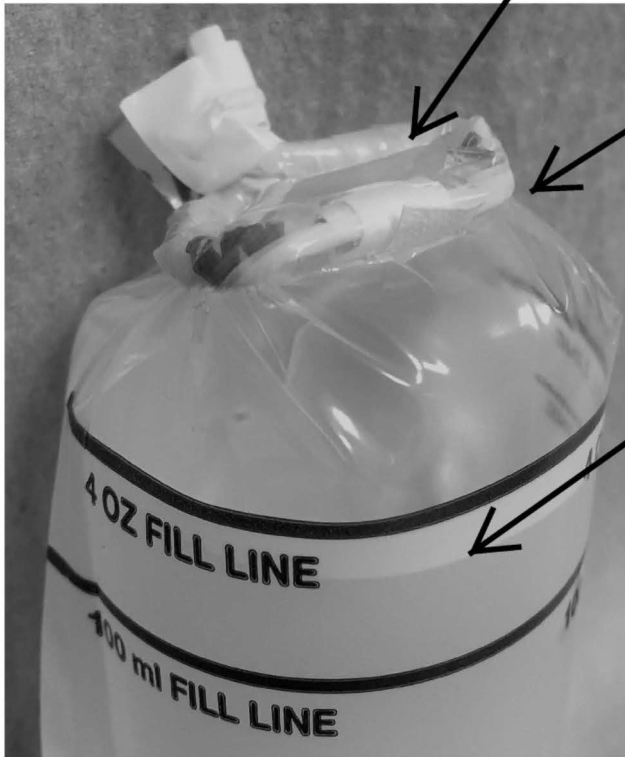

Note how bag is tied

Note where the water is filled to. Must be more than 100 ml fill line when bag is tight.

Name
 Address
 Time/Date
 Sample Location

